

Architecture Advent Calendar

Counting the days
before Christmas
with four styles of
historic architecture

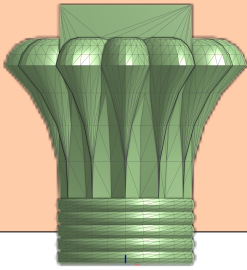

The **Ancient Egyptian** side is modeled after the Temple of Edfu, dedicated to the god Horus and completed in 52 BC. Incriptions on the temple provided valuable translations for Egyptologists.

Aqueducts like those on the **Roman** side brought water to ancient cities, supporting millions of people. Some also served as bridges, like the Pont du Gard in southern France.

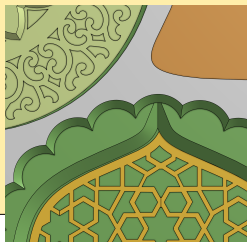
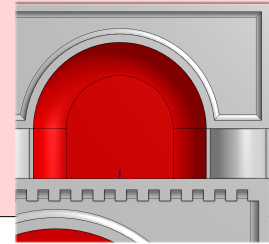

The **Mughal** panel is modeled after the Mysore Palace in Karnataka, India. It used to be the official residence of the Wadiyar dynasty and the seat of the Kingdom of Mysore.

The **Tudor** side represents the final style of Medieval architecture developed in England and Wales, beginning in 1485. Tudor houses later spread through Northern Europe and the US.

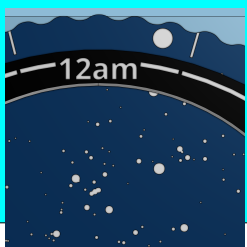
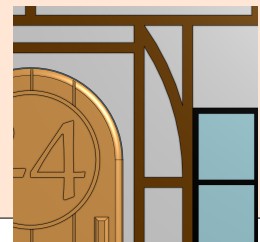

The **Planisphere** on top of the calendar calculates the positions of stars. Align the large dot on the edge of the wheel with the time on the outer frame to see the northern hemisphere night sky on Christmas Eve.